

# Plates

## Groutable Cable Volcano Plate - 63T Sumo Cables

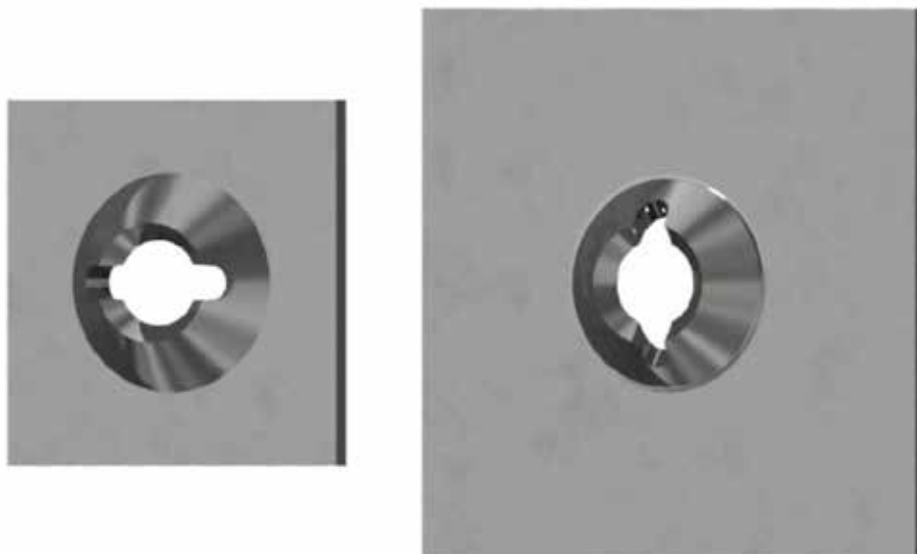

### Features:

- Dome profile allows for 18° angles of alignment when installing the cable bolt with a domed barrel
- Grout indicator slots

Dimension (mm)	Thickness (mm)	Hole diameter (mm)	Minimum Collapse Load (kN)	Minimum Pull through load (kN)	Mass (kg)	Standard pack
200 x 200	14	46	343	540	4.3	200
300 x 300	14	46	343	540	9.8	100

Tested over a 150mm span